

Residential Foundation Handout

Concrete Foundation 4'6" Wall Height (Maximum)

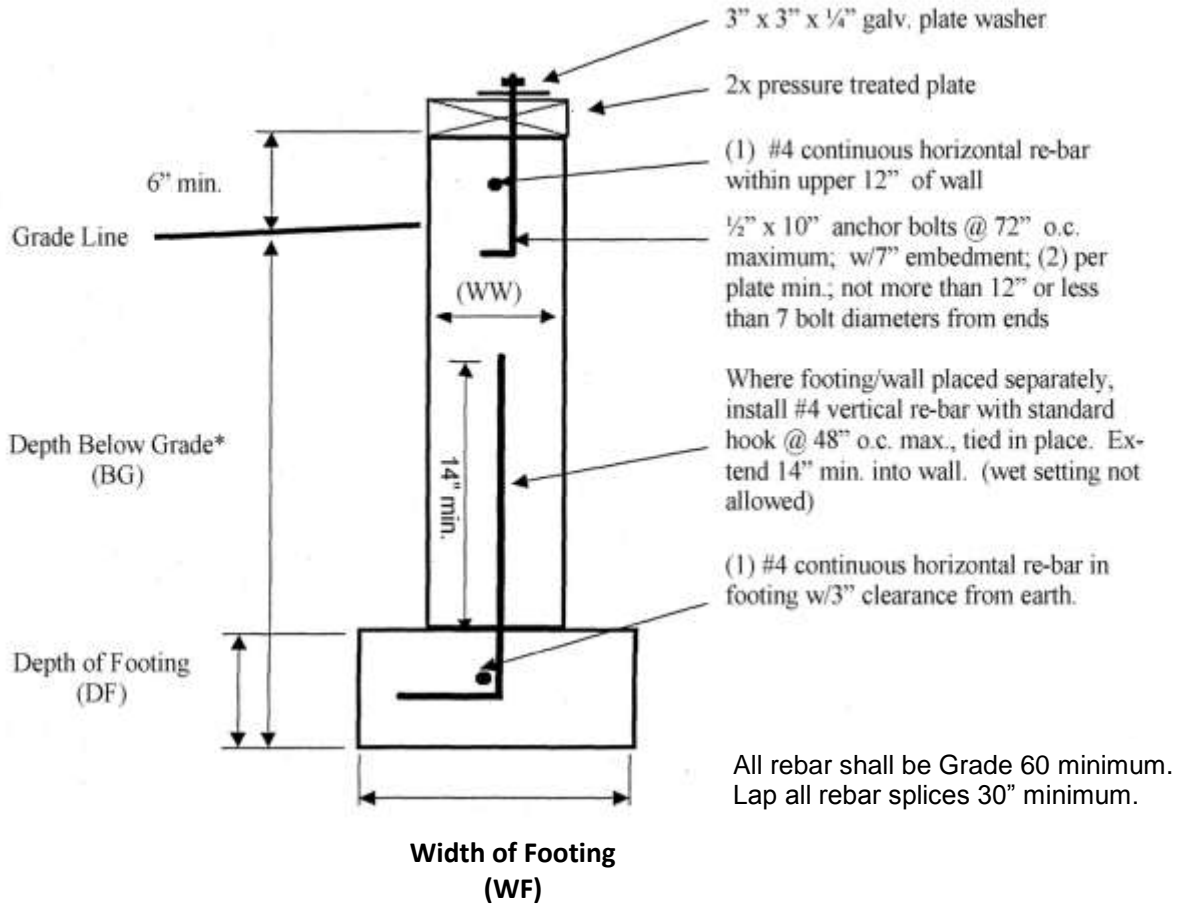

	WF	DF	BG	WW
One Story	12"	6"	12"	6"
Two Story	15"	6"	12"	6"
Three Story	23"	8"	12"	8"

Surface drainage shall be diverted to an approved point of collection so as to not create a hazard. Lots shall be graded so as to drain surface water away from foundation walls. The grade away from foundation walls shall fall a min. of 6 in. within the first 10 ft. Exception: where lot lines, walls, slopes, or other physical barriers prohibit 6 in. of fall within 10 ft. drains or swales shall be provided to ensure drainage away from the structure. (R401.3)

Created 3/18/2013

Residential Foundation Handout

Monolithic Slab Foundation

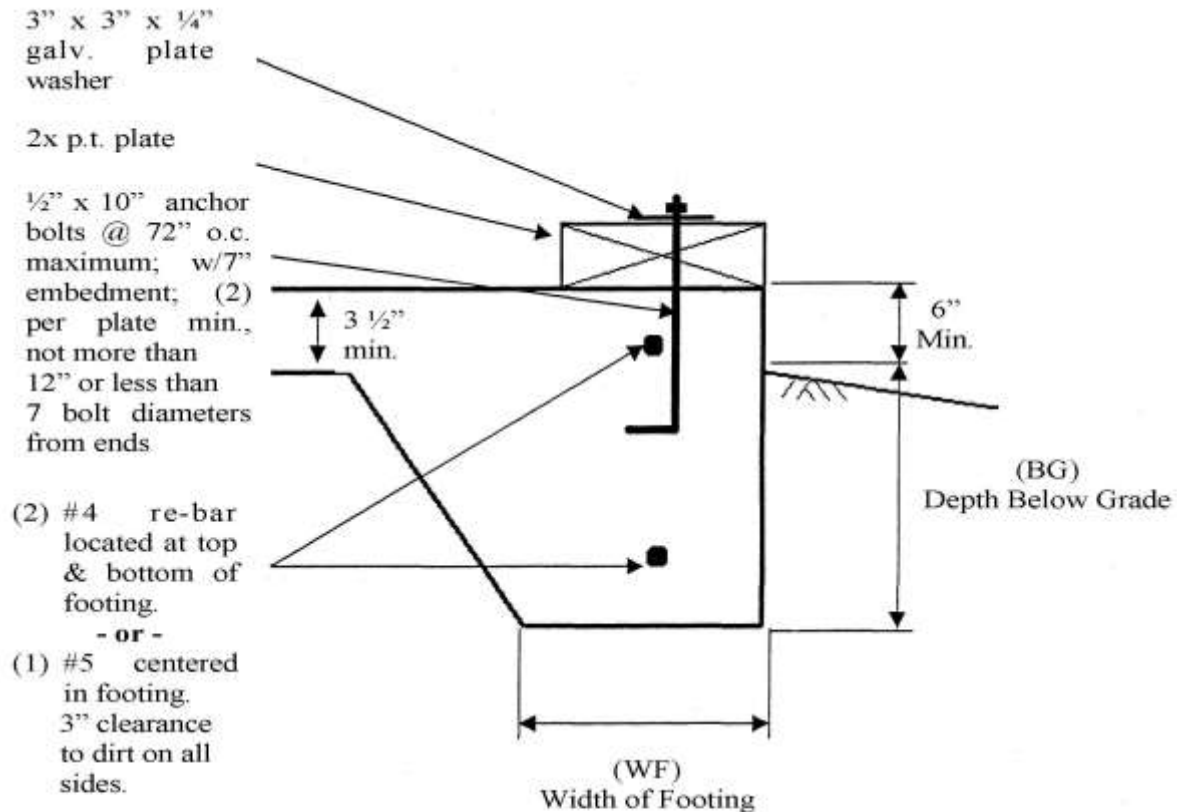

	WF	BG
One Story	12"	12"
Two Story	15"	12"
Three Story	23"	12"

WSEC R-10 slab insulation shall be installed to create a thermal break between heated and un-heated spaces. The insulation shall extend downward from the top of the slab to the bottom of the footing around the slab perimeter at heated areas. Monolithic slabs shall also include R-10 insulation under the entire non-load bearing portions of the slab at all heated areas.